

"Always do your best, What you plant now, you will harvest later"



## SRI GANESHRAAM ENTERPRISES

Mfg. Silicon / Viton-Transparents, Opaque, Tubes,  
Sleeves, Chords, Wires and Cables



**KUMARESAN.P**

**ASST-MANAGER**

**SOURCING & SUPPLY CHAIN - SALES & MARKETING**

**+91-9094948837 | SALES@SRIGANESHRAAM.COM**

# WELCOMES YOU!

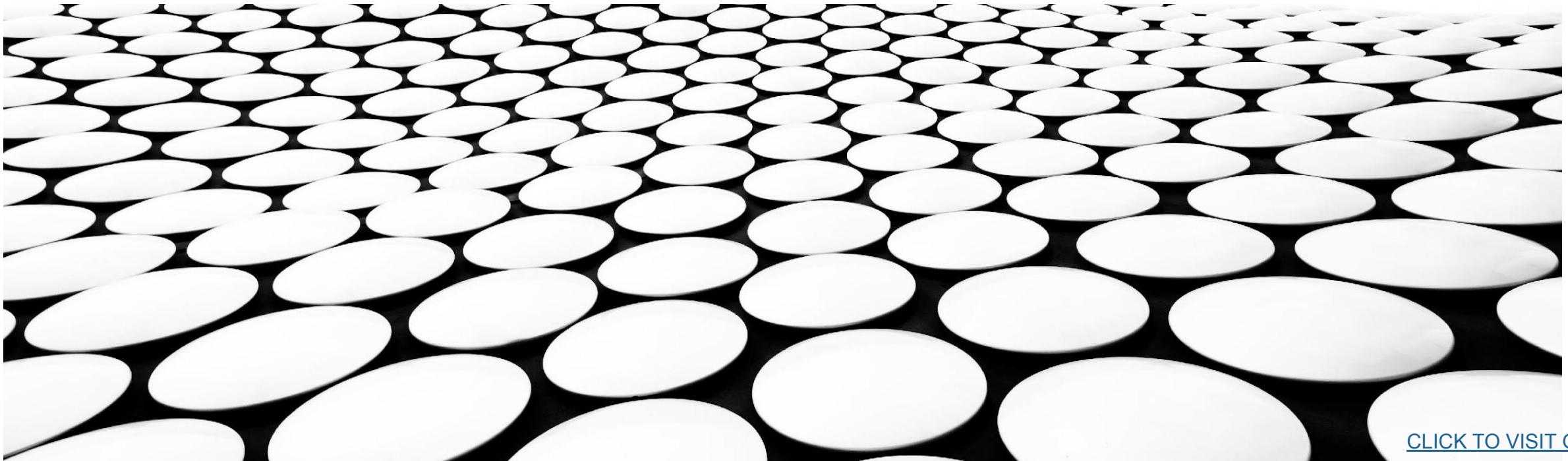

[CLICK TO VISIT GRE](#)

ADDRESS: PLOT NO.2,3&4, SHANTHI SANTHOSH NAGAR,(BEHIND ANDREW YULE COMPANY) KANDANCHAVADI,CHENNAI-600095

PH. : (044)-42152474, 42115923 E-MAIL : SRIGANESHRAAM1@GMAIL.COM



# AN OVERVIEW OF GRE

STRIVING TOWARDS SUCCESS THROUGH INNOVATION



- From the year of 1996 we have a rich experience in the automotive industry, GRE today is a first class manufacturer of Moulded and Extruded Rubber & Plastic parts for Automotive OEM's around the India. The GRE plant are IATF 0345861 : 2018, BSI:699271 certified and meet the most stringent quality norms set by its diverse range of customers, We are supplying to Automotive, Agriculture, medical & Electronic industries, Our major customers in India like TAFE, ROYALENFIELD, WINGS, VARROC, SPARK MINDA, MOTHERSON, LIFELINE SYSTEM, APPASAMY MEDICAL SYSTEM, LUBDUB MEDICAL, SLG INDUSTRIES, GREAVES COTTON etc. for their critical rubber requirements.
- GRE has a unique capability to process rubber parts in all grades like NR, NBR, SBR, EPDM, Silicon, Viton, Neoprene, HNBR, Fluoro, Isoprene, Hyplone, etc., and plastic parts in grades like DMC (Dough Moulding Compound), It therefore offers a 'one stop shop' engineering solutions to all the customers through its expertise in designing, development, tooling, moulding, extrusion, assembly, painting, testing and delivery capabilities across the India. Backed by its technical capabilities and highly enthusiastic workforce, GRE today has become a supplier of choice for the Automotive industry across the India.



## VISION

“ To be customer first choice as a supplier of high quality and reliable products. With quality services that exceeds the expectations of our esteemed customers and continuously create new opportunities for growth in our strategic business ”.

## MISSION

“Our main mission is growing with customer satisfaction” The company is driven by the passion to secure customer delight by ensuring quality products and services.

## OUR TECHNICAL TEAM

“We at GRE, do believe that it is soldiers who win the war. No latest technology can work out to be a success without equally skilled technical staff. We are always concerned about the periodical training of the production staff along with the quality control staff to ensure better use of the technology adopted. All necessary steps are taken to meet the workers requirements in lieu of which we win their confidence, moral support & above all their hardcore efforts & dedication which makes us always stand on the winners’ side.

## OUR INFRASTRUCTURE

“Our infrastructure is build by renowned engineers. With efficient use of available floor space we are able to achieve streamlined production run. Our firm consists of administrative, marketing, financial and operative departments. these departments are equipped with necessary safety requirements. Our well developed logistic network helps in speedy delivery of products.



# SRI GANESHRAAM ENTERPRISES

## OUR STRENGTH

### PLANT VIEW

- Year of Establishment - 1996
- No of Employees - 68
- Top Management - 3
- Technical - 2
- Quality Team - 15
- Staffs - 10
- Workers - 38
- Area in SqFt - 18,000 sq
- Location - [Kandanchavadi,Chennai-600 096](#)  
[Tamilnadu](#)

[CLICK TO VISIT GRE](#)



# OUR MAJOR CUSTOMERS AND PRODUCT LINES



- AUTOMOTIVE,
- AGRICULTURE,
- MEDICAL AND PHARMA INDUSTRY,
- ELECTRONIC AND HOME APPLIANCES,



### KNEADER MACHINE



- Kneader machine with 30 kg capacity 2 NOS
- Production Handling Capacity – 150 Tons / Month

### POLYMERS USED

- NATURAL
- SBR
- NBR / HNBR
- NBR PVC
- EPDM
- VITON
- SILICONE
- NEOPRENE
- POLYURETHANE
- POLYACRYLIC
- DMC (Dough Moulding Compound)

# AUTOMATED CARBON WEIGHING SYSTEM



- FIFO & Accurate Weighing for weighing systems in carbon for ERROR proofing,
- Handling 3 Tons of Carbon at a time



# AUTOMATED OIL WEIGHING SYSTEM



- FIFO & Accurate Weighing for weighing systems in oil for ERROR proofing,
- Handling 7 Tons of Oil at a time





# AUTOMATED CHEMICAL WEIGHING SYSTEM



- Controlled Chemical Storage,
- Each Container 25 Kg Capacity,
- Handling 300 Kg of Chemical,





## OPEN MILS

- Mill 4 nos each 30 tons / month
- Open mill for New Developments,
- Compound Improvements,
- Production Handling Capacity – 30 Tons / Month,



## CHILLING PLANT

- CHILLING PLANT FOR EXTRUDED, WARMING MILL & KNEADER M/C, CAPACITY-15 TONNAGE,
- REMOVING RUST PREVENTIVE IN PIPE LINES AND GIVING CONSISTANT COOLING SYSTEM TO IMPROVE COMPOUND QUALITY AND BETTER PRODUCTION.





# AUTO BLANKING AND STRIP CUTTING FACILITY

## STRIP CUTTING

- Advanced Auto Pre former Machine that Maintain uniform blank and strip weight & size,
- Blade Cutting Speed – 250 RPM,
- Production Handling Capacity – 45 Tons / Month,



## RUBBER CUTTING



## BLANK CUTTING



## TENSILE MACHINE

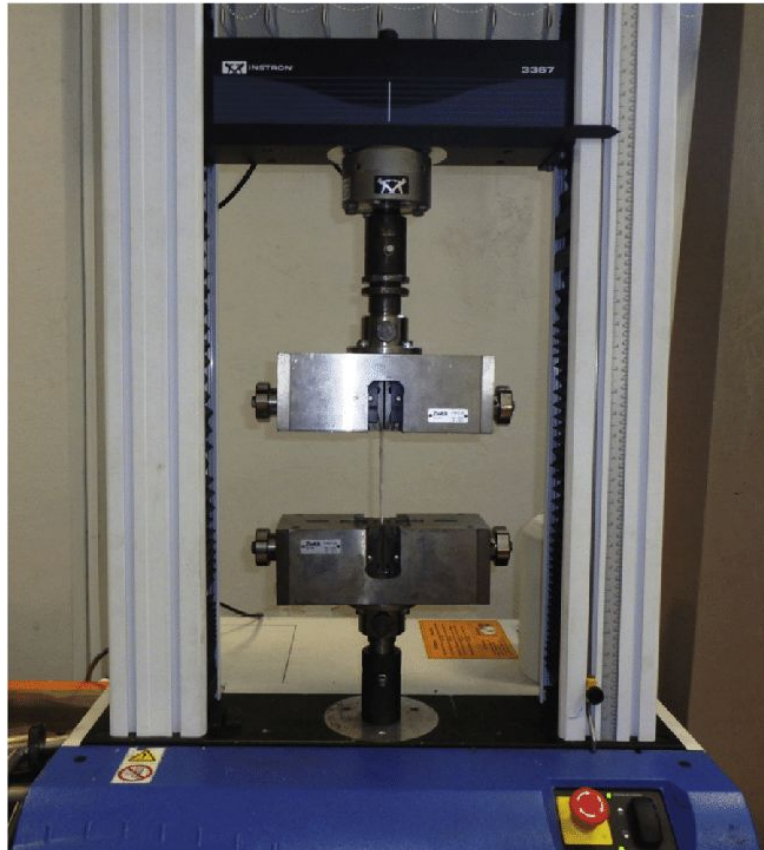

To test the tensile and elongation of the parts.

## IRHD HARDNESS TESTER



To check the part hardness  
100% accuracy.

## SHORE 'A' HARDNESS TESTER



To avoid the man to man variation  
error in hardness testing of the parts.

# LAB-RESEARCH & DEVELOPMENT

MOONEY VISCOMETER



TENSILE TESTING



RHEOMETER



PROFILE PROJECTOR



To check the quality of compound and component with the help of RHEO, TENSILE, ELANGATION, DIMENTIONS and SPECIFIC GRAVITY testing.



## HOT AIR OVEN



To check the HEAT AGEING & COMPRESSION SET .

## DENSIMETER



## MUFFLE FURNACE



To check the ASH CONTENT .

# LAB-RESEARCH & DEVELOPMENT

## TESTING FACILITIES AVAILABLE

### FOR RUBBER COMPOUND TESTING

S.NO	TYPE OF TEST	MACHINE	MAKE	YEAR OF MAKE
		AVAILABLE		
1	TENSILE STRENGTH, ELONGATION, TEAR STRENGTH	TENSILE TESTING MACHINE	BLUESTAR	1999
2	HARDNESS SHORE A	HARDNESS TESTER -RANGE 0 - 90°A	MITUTOYO	2000
3	HEAT AGEING OVEN FOR AGEING TEST, OIL RESISTANCE	AIR CIRCULATED OVEN - RANGE 0 -250°C	ROYAL	2000
			INDUSTRIES,	
			CHENNAI	
4	COMPRESSION TEST	COMPRESSION TEST TOOL	SELF -FABRICATED	2000
5	98 % CURE AND MOONEY VISCOSITY	RHEO MOONEY MACHINE	MICROVISION	2016
			ENTERPRISES	
6	IRHD HARDNESS CHECKING	IRHD HARDNESS TESTING	PRESTO	2018
7	ASH CONTENT	MUFFLE FURNACE	PRESTO	2018

### RUBBER HOSE TESTING ON PRODUCT

S.NO	TYPE OF TEST	MACHINE	MAKE	YEAR OF MAKE
		AVAILABLE		
5	BURST PRESSURE TEST AS PER IS 443	BURST PRESSURE TESTING	SELF FABRICATED	2004
		APPARATUS		
6	VACUUM COLLAPSE TEST	VACUUM PUMP WITH ACCESSORIES	SELF - FABRICATED	2004
7	ADHESION TEST(PLY TO COVER) IS 3400 (PART-1986)	TENSILE TESTING EQUIPMENT	BLUESTAR	1999



# MOULDING FACILITY

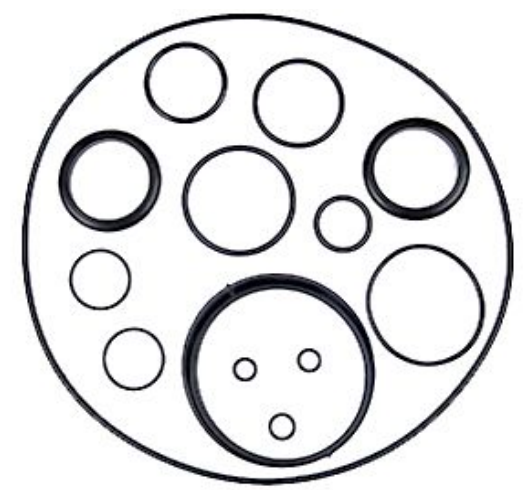

# MOULDING FACILITY



## HYDRAULIC VACUUM COMPRESSION MOULDING MACHINE



- Fully Automatic TAIWAN Hydraulic Vacuum Compression Moulding Machine,
- Vacuum Chamber covered the full heating, platen area ensures the uniform heat to reduce
- the cure time at least by 25% less.
- High speed Vacuum system design – Eliminates air bubbles inside the moulded products with zero defect quality.
- Huge production & Zero defect quality.
- 2 nos, Bed Size – 18 " X 18 " , 200 tonnage each,



# MOULDING FACILITY



## HYDRAULIC COMPRESSION MOULDING MACHINE

- Fully Automatic JIA XIN Hydraulic Compression Moulding Machine,
- Huge production & Zero defect quality.
- 8 nos, Bed Size - 24 " X 24 " , 250 tonnage each,



# MOULDING FACILITY



## HYDRAULIC COMPRESSION MOULDING MACHINE

- Semi Automatic Hydraulic Compression Moulding Machine,
- 2 nos, Bed Size - 16 " X 16 " , 150 Tonnage each,
- 2 nos, Bed Size - 14 " X 14 " , 100 Tonnage each,
- 1 nos, Bed Size - 14 " X 14 " , 100 Tonnage, 3 Platen,
- 2 nos, Bed Size - 12 " X 12 " , 50 Tonnage each,
- 2 nos, Bed Size - 10 " X 10 " , 10 Tonnage each
- Totally we have 9 nos of Semi Automatic Hydraulic Compression Moulding Machine,



# MOULDING FACILITY

## MANUAL COMPRESSION MOULDING MACHINE



- Manual Hydraulic Compression Moulding Machine,
- 1 nos, Bed Size - 14 " X 14 ", Manual Tonnage,
- 2 nos, Bed Size - 12 " X 12 ", Manual Tonnage each,
- 1 nos, Bed Size - 10 " X 10 ", Manual Tonnage each
- Totally we have 4 nos of Manual Hydraulic Compression Moulding Machine,



# HOSE FACILITY





# HOSE FACILITY

## TYPES OF HOSES WE CAN PRODUCE

- Radiator and Heater Hoses,
- Air Cleaner and CAC Hoses,
- Turbocharger and Inter Cooler Hoses,
- Bi-layer Co-extruded Tubing,
- Branch Hoses,

We are specialized in braided & Non braided hoses, Wrapping Radiator hoses & Air cleaner hoses, Smooth hoses, We have special machine for Knitting & braiding,

Our parts can do Cooling systems of automotive and industrial engines, Resistant to Abrasion, Resistant to Heat, Resistant to Ageing, Resistant to Weather/Ozone.







# HOSE FACILITY

## SPECIAL EQUIPMENTS

- Burst Pressure Testing Machine available for quality for pressure test,
- Pad Printing Machine available for part identification,
- 2 nos of Vulcanizing Machine available for curing purposes,
- We have a special machine for 2 layer and 3 layer hose production,
- We have a machine for cotton and nylon braiding machines,



# EXTRUSION FACILITY



EXTRUDED  
BEADINGS

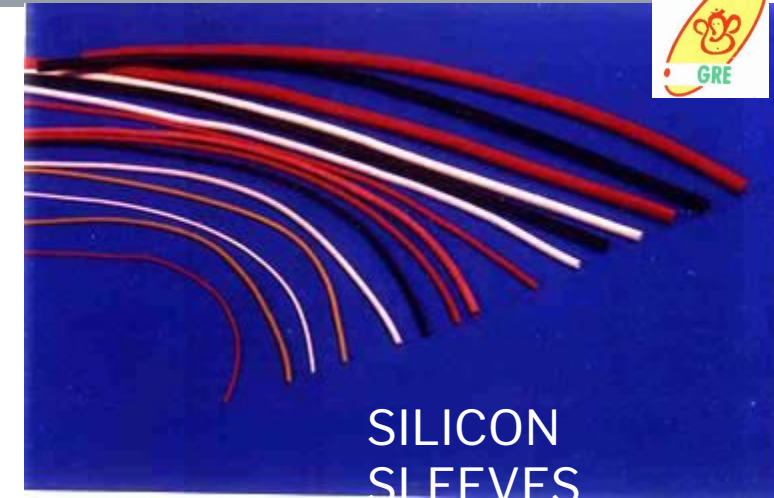

SILICON  
SLEEVES



SILICON  
TUBES



EXTRUDED  
BEADINGS

# EXTRUSION FACILITY

## CONTINUOUS EXTRUSION MACHINE CUM CV CURING SYSTEM



- In this Continuous Vulcanizing process we can make Variety of shapes with Flexible and lightweight products we can produce with Minimal waste,
- Benefits accrued from processing rubber through extrusion are numerous. A wide variety of products can be derived from the process. Through this process, the extruded rubber is not limited in shape or length and can be cut to fit any application. The process is highly efficient and repeatable. By comparison, rubber mouldings are highly limited in applications due to the size of the manufacturing press used. Rubber sheets are, on the other hand, unlimited in size or length but harbour major compromises on tolerance.
- Manual Extruder machine also available

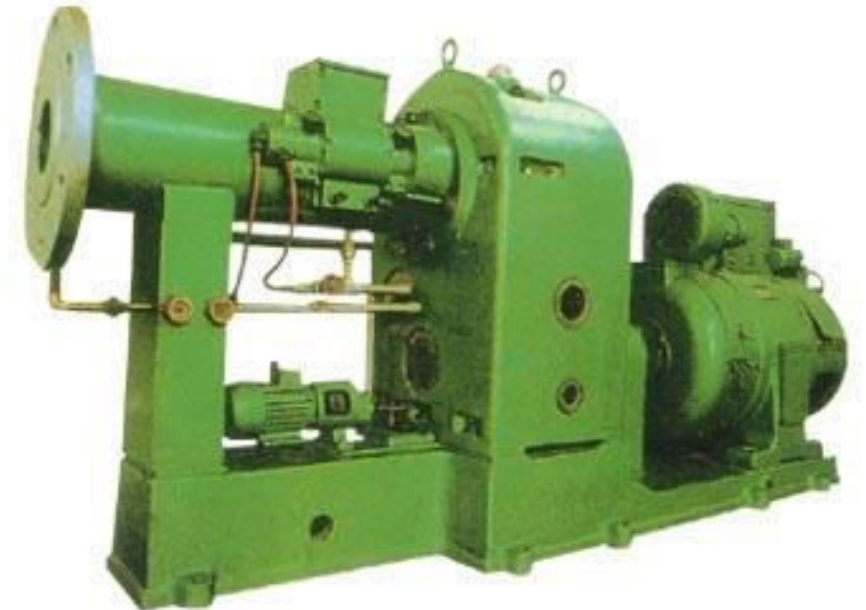

## RWM AND FG STORE AREA

- We have a centralized space for FG parts storage purposes, Here we can store all our HOSE, EXTRUSION, AND MOULDING parts in FIFO wise ,



- We have a space for RWM and CPD storage on ground floor, In future we are planed for AIR- CONDITONING for both storage areas,

# BLASTER CRYOGENIC DEFLASHING



- The process uses liquid nitrogen, barrel rotation and media (steel balls, ceramic balls or other suitable media) in varying combinations to remove the flash in a highly precise, economical and expedient manner.
- As flashes have a much thinner surface area compared to the product, the flashes "FREEZES" very quickly and become brittle. The tumbling action—combined with the impact of the media—removes the flashes without damaging the part itself. Parts that have thin flash can be quickly and thoroughly deflashed. This process is exceptionally good at removing the inner dimensional complex flash that can not be removed by any other method.



# TRANSPORT FACILITY



- We have tie up with GK TRANSPORT,
- The transporter has 3 TATA ACE and 2 EICHER vehicles so these is no delay in delivery,



# QUALITY ASSURANCE



- We appraise The quality Internally From Incoming ,In process And Final Inspection Process and products. Followed by the standards of ISO ,TS & Customer Specific standards.
- Rubber And their Related Raw Materials are Cleared At the Incoming Inspection Process Based On the Mill Certificates Given by the R.M Manufacturer. When the Process Starts materials are Blended By The Formulations Internally. Which Meet Out the Customer Requirements And their Properties.
- Every Products are evaluate By the Desired Proper Lab Instruments and the Each and every Lab instruments Are Calibrated By Term Frequency.
- Customer's Drawings and The Related Paper works are Done Properly by Customer Wise And the Records are file Properly.
- We have final inspection team for 100% Visual inspection and Pre delivery inspection team for 100% Quality assurance, And well trained TRIMMING operators to supply the quality products to our customer,

## QUALITY POLICY

" WE ARE COMMITTED TO ACHIEVE CUSTOMER SATISFACTION BY CONTINUAL IMPROVEMENT METHODS IN PROCESSES OF QUALITY RUBBER MOULDED COMPONENTS. ALSO COMMITTED FOR PERIODICALLY REVIEWING THE EFFECTIVENESS OF THE QUALITY MANAGEMENT SYSTEM. "

# AWARDS AND CERTIFICATES



## Certificate of Registration

QUALITY MANAGEMENT SYSTEM - IATF 16949:2016

This is to certify that:

Sri Ganeshraam Enterprises  
Plot No. 2, 3, 4  
Shanthy Santhosh Nagar  
Kandanchavadi  
Chennai 600 096  
Tamil Nadu  
India



By Royal Charter

operates a Quality Management System which complies with the requirements of IATF 16949:2016 for the following scope:

The Manufacture of Moulded, Extruded and Hose Rubber Products.

Permitted Exclusions: Product Design.

For and on behalf of BSI:

  
Managing Director, BSI India, Venkataram Arabolu

BSI Certificate Number: 699271

IATF Number: 0345861



Certification Date: 2018-12-12

Latest Issue: 2018-12-12

Page: 1 of 1

...making excellence a habit.™

Expiry Date: 2021-12-11

This certificate was issued electronically and remains the property of BSI and is bound by the conditions of contract. An electronic certificate can be authenticated [online](https://www.bsi-global.com/online). Printed copies can be validated at [www.bsi-global.com/ClientDirectory](https://www.bsi-global.com/ClientDirectory) or telephone +91 11 2692 9000. Further clarifications regarding the scope of this certificate and the applicability of IATF 16949:2016 requirements may be obtained by consulting the organization. This certificate is valid only if provided original copies are in complete set. IATF Contracted Office: BSI Assurance UK Limited, registered in England under number 7805321 at 389 Chiswick High Road, London W4 4AL, UK.

BSI, The MIRA Corporate Suites (A-2), Plot 1 and 2, Ishwar Nagar, Mathura Road, New Delhi 110 065. A Member of the BSI Group of Companies.





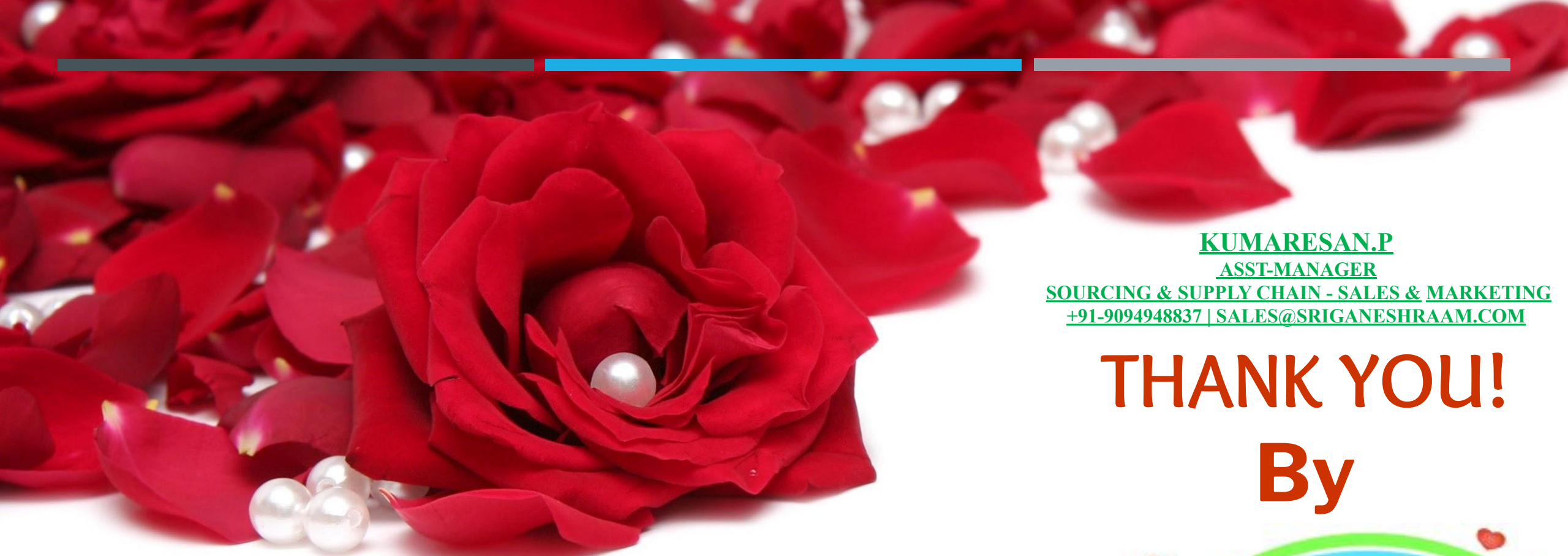

**KUMARESAN.P**  
**ASST-MANAGER**  
**SOURCING & SUPPLY CHAIN - SALES & MARKETING**  
**+91-9094948837 | SALES@SRIGANESHRAAM.COM**

**THANK YOU!**  
**By**

**SHREE GANESHRAAM  
ENTERPRISES**

"If people like you, they'll listen to you, but if they trust you, they'll do business with you."



"We look forward to working with you"



[CLICK TO VISIT GRE](#)

